

# HOW TO SPECIFY PIRTEK HOSE TAILS

## Hose Tail Part Number C629L-2016J

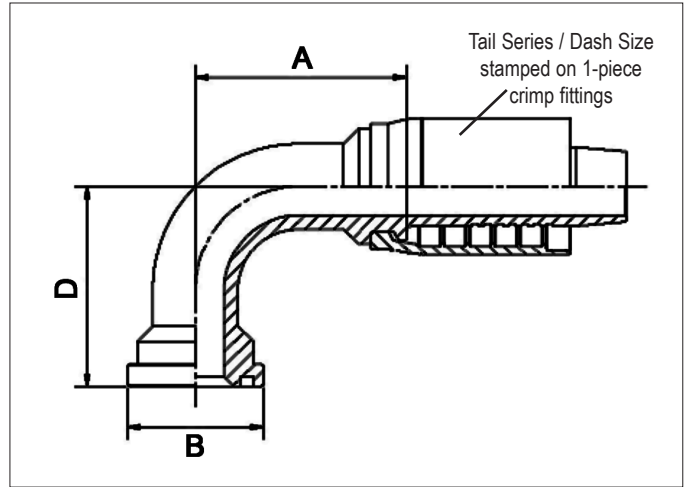

| Configuration   | Angle  | Type  | Fitting Size   | Hose Size   | Series                                       |
|---|--|---|--|---|--|
| <b>C62</b>  | <b>9</b>   | <b>L</b>  | <b>20</b>  | <b>16</b>   | <b>J</b>                                     |
| End configuration and angle are listed on the next page | 1 = straight<br>2 = 22° bend<br>3 = 30° bend<br>4 = 45° bend<br>6 = 60° bend<br>7 = 67° bend<br>9 = 90° bend | L = long drop<br><br>C = compact<br>or<br>C = Caterpillar | Defined by type of end connection i.e. thread, flange, tube, banjo etc. See the identification table | - 03 = 3/16" ID<br>- 04 = 1/4" ID<br>- 05 = 5/16" ID<br>- 06 = 3/8" ID<br>- 08 = 1/2" ID<br>- 10 = 5/8" ID<br>- 12 = 3/4" ID<br>- 16 = 1" ID etc. | J Series<br>K Series<br>H Series<br>T Series |
| C62 refers to an SAE Code 62 flange fitting             | 9=90° bend   | L = long drop   | Flange OD (Dim. B) = 53.98 mm for size 20 Code 62 flange   | Hose ID is 1" for dash 16 hose  |  |

Possible combinations of these 3 items are as listed on the next page. Note that for some situations, the position of the 'L' can vary from the example given above.

Hose ID for 100R5 and its variants differ from 1/16" convention. Refer to the specific hose table for details.

**K, J, H and T Series Fittings are stamped on the Ferrule of the Hose Tail as illustrated above**

| Tail Series | Application                                   |
|-------------|---|
| K / J       | Braided & multi-spiral hoses for general use. |
| H           | More demanding multi-spiral applications      |
| T           | STH, MPH and thermoplastic hoses              |
| 932/934/954 | Large bore hoses                              |

| Tail Series | Application   |
|-------------|---|
| A           | SAE 100R5 dimensioned hoses<br>A = field attachable             |
| P           | Push-on fitting for low pressure textile braided hoses          |
| I           | Interlock attachment for extreme multi-spiral applications      |
| L           | Low pressure tail for suction and return hoses (clamp required) |

# QUICK GUIDE TO PIRTEK PRODUCT CODES

All codes require size information and the appropriate hose tail Series (Suffix) to allow a complete Product Code to be assembled. See page C 1 for a guide to ordering

| Type of Fitting             | Straight   |         |        | Elbow Fitting |       |       |       |       |       |          |
|-----------------------------|--|---------|--------|---------------|-------|-------|-------|-------|-------|----------|
|                             | Unthreaded   | Male    | Female | 22°           | 30°   | 45°   | 60°   | 67°   | 90°   | 90° Long |
| Banjo BSP                   | BB1  |         |        |               |       |       |       |       |       |          |
| Banjo Metric                | BM1  |         |        |               |       |       |       |       |       |          |
| BSP Flat Face               |  |         | BFF1   |               |       |       |       |       |       |          |
| BSP                         |  | BPM1    | BF1    |               |       | BF4   |       |       | BF9   | BFL9 †   |
| BSP Compact                 |  |         |        |               |       |       |       |       | BFC9  |          |
| BSPT                        |  | BTM1    |        |               |       |       |       |       |       |          |
| JIC                         |  | JM1     | JF1    |               |       | JF4   |       |       | JF9   | JFL9     |
| JIC Compact                 |  |         |        |               |       | JFC4  |       |       | JFC9  |          |
| JIS / BSP (Mitsubishi)      |  |         | JBF1   |               |       |       |       |       |       |          |
| JIS / Metric (Komatsu)      |  |         | JMF1   |               |       |       |       |       |       |          |
| Kärcher                     | KT1  |         |        |               |       |       |       |       |       |          |
| Kobelco                     |  | KOBM1   |        |               |       |       |       |       |       |          |
| Metric GAZ (French)         |  |         |        |               |       |       |       |       |       |          |
| Metric heavy (DKS / DKO)    |  | DSM1    | DSF1   |               |       | DSF4  |       |       | DSF9  |          |
| Metric Multi Seal (DKL)     |  |         | DMSF1  |               |       |       |       |       |       |          |
| Metric light (DKL)          |  | DLM1    | DLF1   |               |       | DLF4  |       |       | DLF9  |          |
| Metric Face Seal (Chinese)  |  |         | MOF1   |               |       |       |       |       |       |          |
| NPT                         |  | NM1     | NF1    |               |       |       |       |       |       |          |
| ORFS                        |  | OM1     | OF1    |               |       | OF4   |       |       | OF9   | OFL9     |
| SAE                         |  | SM1     | SF1    |               |       | SF4   |       |       | SF9   |          |
| SAE Compact                 |  |         |        |               |       |       |       |       | SFC9  |          |
| SAE Inverted Flare swivel   |  |         |        |               |       |       |       |       |       |          |
| SAE Flange Code 61 3000 psi | C611   |         |        | C612          | C613  | C614  | C616  | C617  | C619  | C619L    |
| SAE Flange Code 62 6000 psi | C621   |         |        | C622          | C623  | C624  | C626  | C627  | C629  | C629L    |
| 'Supercat' Flange 9000 psi  | C621C  |         |        | C622C         | C623C | C624C | C626C | C627C | C629C |          |
| JIS Flange (Komatsu)        | As for SAE Flange Code 61 except with 'K' prefix. Example: KC611 |         |        |               |       |       |       |       |       |          |
| Joiner (2-ended hose tail)  | HJ   |         |        |               |       |       |       |       |       |          |
| Standpipe Imperial          | SPI1   |         |        |               |       | SPI4  |       |       | SPI9  |          |
| Standpipe Metric            | SPM1   |         |        |               |       | SPM4  |       |       | SPM9  |          |
| SKV                         |  |         |        |               |       |       |       |       |       |          |
| SSKV                        |  |         |        |               |       |       |       |       |       |          |
| Staple Lock                 | SLM1   |         |        |               |       | SLM4  |       |       | SLM9  |          |
| Staple Lock Super           | SSLM1  |         |        |               |       |       |       |       |       |          |
| UNO (SAE O-Ring Boss)       |  | OBM1    |        |               |       |       |       |       |       |          |
| UNO Swivel                  |  | OBSM1/9 |        |               |       |       |       |       |       |          |
| Weld on Tail (Lifesaver)    | WO1  |         |        |               |       |       |       |       |       |          |

## HOSE TAIL SERIES PHYSICAL APPEARANCE

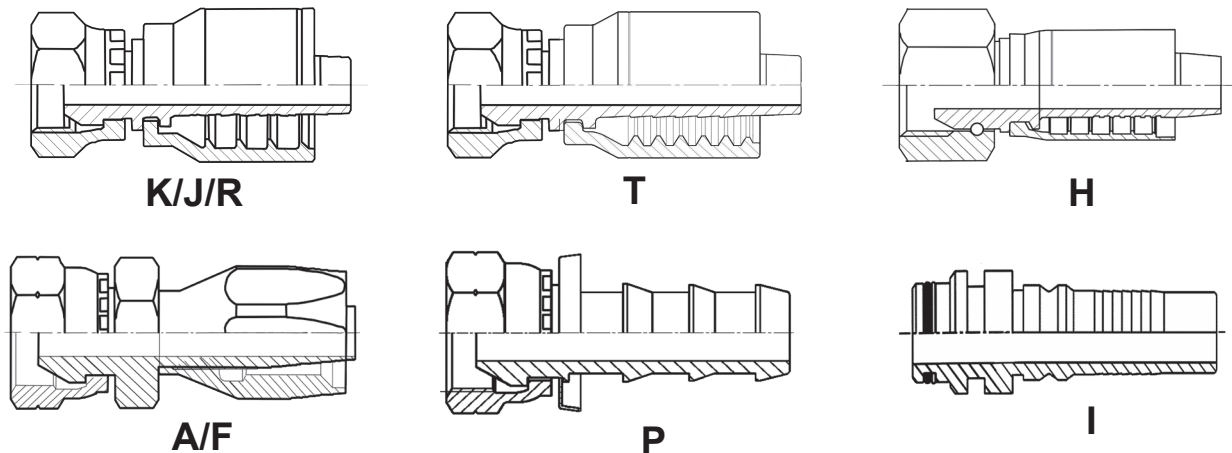

Note that the Industrial tails (INDUST above) are not documented in this Catalog. Please consult Mining or Industrial Fittings Sections for details. "R" series fittings are not Department of Transportation (D.O.T) approved.